

# Salamander IP67 (Nema 4 + 6) Industrial Camera Enclosure



IP67 protection for compact MV cameras up to 40x40mm cross section with rear walls A, B, C, D

## Technical Highlights:

- **Robust build** aluminium extrusion profile.
- **Small form factor** easy to integrate into existing machines.
- **Flexible camera positioning** (angle and position).
- **Dovetail profiles enable robust enclosure mounting** on all 4 sides along the entire profile. Mounting brackets resist a displacement force of up to 3000 N! Simple adjustment of working distance.
- **Compatible with large range of accessories:** variety of mounting and adjustment brackets, water cooling, controlled heating plate, wind curtain, pneumatic shutter, positioning ring for simple camera replacement, and more.
- **High chemical resistance** due to Viton, NBR and TPE sealing materials. Contact us for any special requirements!



- **Vibration proof mounting and passive camera cooling** with help of autoVimation's patented Quick-Lock and Heat-Guide camera mounting system.
- **Fits all cameras from 29 to 40mm height.** Cameras with 29mm height can be up to 47mm wide down to 40mm width at 40mm high.

## Degree of protection

**IP66** protection from high pressure water jets (equivalent to Nema 4)

and

**IP67** protection from occasional submersion (equivalent to Nema 6)

max water depth: down to 1m  
max. duration: up to 1 hour

## Dimensional details

for up to 40x40mm cross section

allows for assembly of connectors up to 26mm Ø

Salamander S, length: 171, 136 (overall, internal)

Salamander M, length: 203, 189 (overall, internal)

Salamander L, length: 233, 219 (overall, internal)

Special lengths available up to 400mm internal length

Clear aperture - Ø with 2" window: 45mm Ø

Lens - Ø up to 55mm Ø

## Material details

Enclosure: anodised Aluminium

Window: BK7, broadband anti-reflective coating both sides

Window seal: Viton

Enclosure seal: NBR (Viton at request)

Cable gland seal: TPE (TPEV at request)

# Salamander IP67 (Nema 4 + 6) industrial Camera Enclosure

## Dimensions:

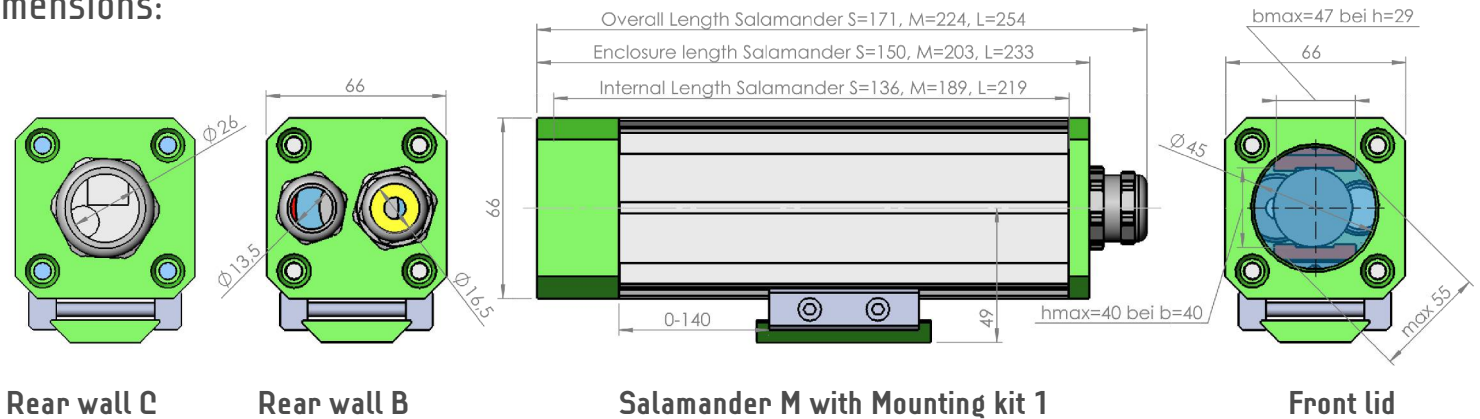

## Accessories:

- **Mounting kits 1-11** (refer to brochure "[Camera Enclosure Mounting kits](#)")
- **Wind curtain and pneumatic shutter** for dirty environments
- **60mm extension piece** for easier adjustment of large lenses
- **Water cooling and heating**
- **Electric heating plate with temperature control**
- **Positioning ring** to allow for repeatable camera assembly
- **Triangulation building kit** (refer to brochure "[Mounting solutions for 3D Machine Vision](#)")



Mounting Kit 7



60mm Extension



Wind Curtain

## Order number key for standard Salamander enclosures:

Example: Salamander M, Rear Wall B, for Basler Ace (h x w x l = 29 x 29 x 42):

Art. No.:	<u>2</u>	<u>0</u>	<u>.3</u>	<u>1</u>	<u>1</u>	<u>.192</u>
	↓	↓	↓	↓	↓	↓
Camera enclosure	Camera height	Length camera body smaller than:	Salamander	Rear Wall B	Enclosure size: M	
	29: 0 30: 1 31: 2 32: 3 33: 4 34: 5	35: 6 36: 7 38: 8 40: 9 92mm: 7		Rear wall A: 0 Rear wall B: 1 Rear wall C: 2 Rear wall D: 3	S: 139 M: 192 L: 222	

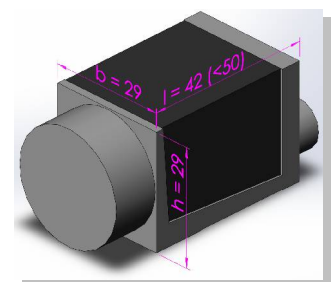

### Relevant dimensions:

Only the length of the rectangular camera body is relevant for ordering the right enclosure (l = 42mm in above image).

For further information refer to the brochure: "[Camera enclosures and Camera Mounting Blocks](#)"